



P/N 5702150



SALES DESCRIPTION

- For Sammic rack conveyor dishwashers.
 Specially designed to suit each user's specific needs.
- ✓ Roller units with free turn and tank.
 - ✓ In 90°, possibility of coupling to 180°.
 - ✓ Hinged models available, to fit 180° machined curves.

SPECIFICATIONS

Crated dimensions
 800 x 800 x 400 mm
 Gross weight: 38 Kg





CR-90 90° CURVE WITH FEET

P/N 5702150



WARE WASHING
RACK CONVEYOR DISHWASHERS

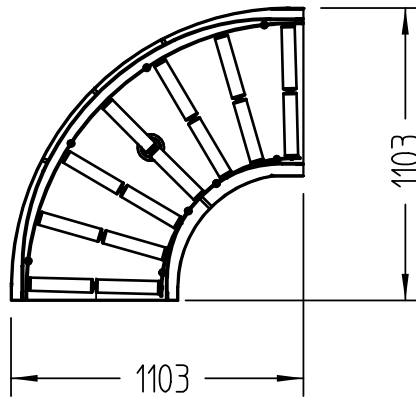
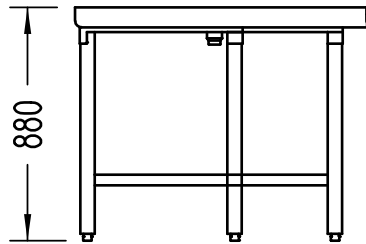

sammic | www.sammic.com
Food Service Equipment Manufacturer
Polígono Basarte, 1. phone +34 943 15 72 36
20720 Azkoitia, Spain sales@sammic.com



Project	Date
Item	Qty
Approved	

product sheet
updated 03/08/2022